



*Office-in-an-Hour™*

**Office in an HOUR™**  
the fastest way to a durable workspace™



**10 Year Commercial Warranty**

Storage Kit Includes File, Cabinet, and Paper/Pencil Storage

**Features Include:**

- Complete freestanding, panel-based administrative workstations that assemble in one hour or less
- Durable melamine surfaces resist scratches and stains
- Add on Storage Kit helps to organize your workspace and includes File, Cabinet, and Paper/Pencil Storage
- Meets ANSI/BIFMA standards for safety and performance



Straight Workstation w/Panels

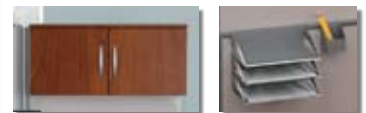

**Finish Available:**  
Hansen Cherry



	MODEL #	DESCRIPTION	DIMENSIONS	LIST PRICE
	<b>WC3649403</b>	L-Workstation w/Panels	64½"W x 64½"D x 63"H	\$1,456.00
	<b>WC3649203</b>	Straight Workstation w/Panels	64½"W x 32½"D x 63"H	\$1,041.00
	<b>WC3649603K</b>	U-Workstation w/Panels	64"W x 32½"D x 63"H	\$2,189.00
	<b>WC3649103</b>	Reception Gallery	63½"W x 12"D x 1"H	\$197.00
	<b>WC3649003</b>	Storage Kit Includes File, Cabinet & Paper Pencil Tray	16"W x 20"D x 25½"H (File) 32"W x 13½"D x 13½"H (Cabinet)	\$624.00
	<b>AC9980103</b>	Articulating Keyboard Shelf	24½"W x 19½"D x 7½"H	\$247.00



L Workstation w/Panels



**STANDARD FEATURES:**

- High file drawer sides accept hanging files
- HON "One Key" interchangeable core removable locks
- Central locking center drawer
- Legs ship unattached
- Mitered drawer fronts
- Meets or exceeds ANSI/BIFMA and ISTA performance standards
- The HON® Limited Lifetime Warranty



Shown in Cumbian Walnut/Black

**Total List: \$1,407.00**  
(Includes: C, D)  
Shown in Medium Oak/Putty

**(A) P3266L**

Left Single Pedestal Desk  
66"W x 30"D x 29½"H  
List: \$829.00

**(C) P3265R**

Right Single Pedestal Desk  
66"W x 30"D x 29½"H  
List: \$829.00

**(E) P3262**

Double Pedestal Desk  
60"W x 30"D x 29½"H  
List: \$899.00

**(B) P3235R**

Right Return  
42"W x 24"D x 29½"H  
List: \$578.00

**(D) P3236L**

Left Return  
42"W x 24"D x 29½"H  
List: \$578.00

**(F) P3251R**

Right Single Pedestal Desk  
48"W x 30"D x 29½"H  
List: \$737.00



*(A-G) Finishes Available:*

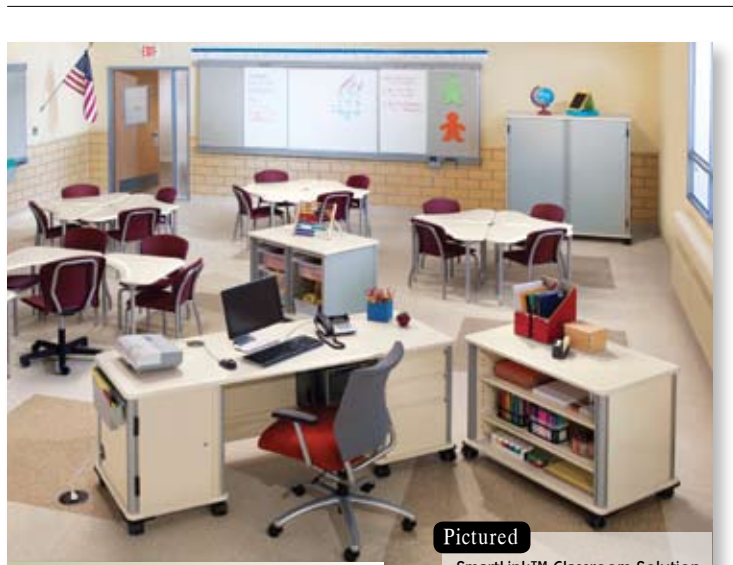
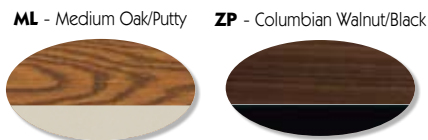

**Pictured**

SmartLink™ Classroom Solution  
Featuring Desks, Storage and  
Wall Rail System.

**Series Details...**



**Secure Storage...**  
Storage options include  
trays, locking file/  
file or box/box/file  
configurations.



**End Panels...**  
Removable to access  
standard power  
management cabinets  
on both ends.

*Greater Technology  
Support, Increased Leg  
Room and More Storage  
than Traditional Desks.*



**34000 Series**

**(G) 34962**  
Double Pedestal Desk  
60"W x 30"D x 29½"H  
List \$864.00



**SmartLink™ Modular  
Classroom Solution**

**STANDARD FEATURES:**

- Teacher Station and storage cabinets are mobile with heavy duty casters
- Teacher Station offers greater technology support, increased leg room and more storage than traditional desks. Optional accessories such as desktop USB and Power hubs, side panel power kit and CPU holders further enhance functionality
- Mobile storage is available in several sizes with choice of optional shelves or trays
- Students desks are shaped for individual or collaborative work with optional book basket, backpack hook, has a comfort edge on top and adjustable height legs
- Wall rail system allows multilayered use of whiteboards, tackboards and optional worksurfaces can be attached for additional study stations



**38000 Series**

**Pictured**

**Total List: \$3,420.00**  
(Includes: A, B, C, D)  
Excludes Chair.

The HON® Limited Lifetime Warranty is your assurance of quality, value and dependability.

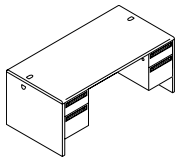

**(A) 38180**  
Double Pedestal Desk  
• Box/File Locking Pedestals  
72"W x 36"D x 29½"H  
List: \$1,317.00

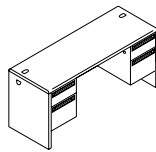

**(B) 38854**  
Kneespace Credenza  
• Box/File Locking Pedestals  
72"W x 24"D x 29½"H  
List: \$1,143.00

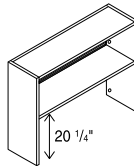

**(C) 38244**  
Open Stack-on Storage  
• Single Shelf  
• Easy-to-Assemble  
72"W x 13¾"D x 36¼"H  
List: \$616.00



**(E) 38155**  
Double Pedestal Desk  
• Box/File Locking Pedestals  
60"W x 30"D x 29½"H  
List: \$1,125.00

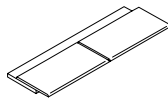

**(D) 38249S**  
2 Doors w/Lock  
• Comes with Core Removable Lock  
• For Hutch (38244NS)  
List: \$344.00



"L" Shaped Workstation with Return on the Right

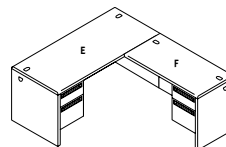

**(F) 38292L**  
Left Single Pedestal Desk  
• Box/File Locking Pedestal  
66"W x 30"D x 29½"H  
List: \$1,081.00

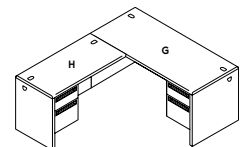

**(H) 38291R**  
Right Single Pedestal Desk  
• Box/File Locking Pedestal  
66"W x 36"D x 29½"H  
List: \$1,081.00

**(G) 38215R**  
Right Return  
• Box/File Locking Pedestals  
48"W x 24"D x 29½"H  
List: \$708.00

**(I) 38216L**  
Left Return  
• Box/File Locking Pedestals  
48"W x 24"D x 29½"H  
List: \$708.00





**38000 Series**

**Pictured**

**Total List: \$3,420.00**  
(Includes: A, B, C, D) - Pg. 56  
Excludes Chairs.



**Series Details...**



**Edge Detail...**  
Radius edge provides a contemporary finish.



**Cord Management...**  
Grommets provide a clean look and allow easy access to cables.



**Pedestal Drawers...**  
Feature full height drawer sides and steel ball-bearing suspension.

*With the 38000 Series, a manager's office can be furnished with practicality and style. Solidly constructed with high-pressure laminate tops, every desk, stack-on storage unit, credenza, peninsula and return is backed by The HON Limited Lifetime Warranty. It's your assurance of long-lasting value, quality and dependability for many years to come. Yet, because productivity and efficiency are important, the 38000 Series is exceptionally well-appointed with outstanding features and options. Flush height worksurfaces provide the manager with a spacious worksurface in a "U" configuration. Stack-on storage units provide storage above the worksurface, optional locking doors are available. Locking pedestal drawers provide security. Finally, for a stylish, contemporary look, the 38000 Series is finished with soft radius edges, full end panels and flush, monochromatic drawer pulls. Meets or exceeds ANSI/BIFMA and ISTA performance standards.*

**Finishes Available:**

**NS** - Mahogany/Charcoal



**SOQQ** - Lt. Gray/Lt. Gray



**SOG25** - Patterned Gray/Charcoal



**SOML** - Medium Oak/Putty



**SO = Special Order**



**Pictured**

**Total List: \$2,460.00**  
(Includes: A, B) - Pg. 56  
Excludes Chair.